



Feel Safe at VEX Worlds

SECURITY

We are working with the Dallas Police Department, DART Police, KBHCC security and additional security support for the safety of everyone.

The KBHCC defines an emergency situation as any incident or situation that affects or has the potential to affect the safety or security of persons in or near the facility, and/or causes damage to the facility. Non-emergency situations are defined as any which disrupt normal facility operations. In the event of an emergency or non-emergency, we want you to know who to call, the do's, the don'ts, and what to remember, depending on the nature of the incident.

If you see something suspicious, please notify a 2022 REC Foundation Staff Member (in a blue REC Foundation logo polo with a staff badge) at:

- Your Division Manager
- Pit Admin
- Guest Services

Do:

- If there is immediate danger, leave the area and do not make contact with the perpetrator or threat.
- Describe the perpetrator or threat (height, weight, age, appearance, size, smell, sounds, etc.) when reporting the situation to the REC Foundation Staff Member. A REC Foundation Staff Member will contact security.
- Identify, if possible, any witnesses and keep others away from the area.
- Stay with the REC Foundation Staff Member to and follow instructions given.

Don't:

- Attempt to disarm, disengage, or neutralize the perpetrator or threat yourself.
- Touch or move suspicious or dangerous objects.

Levels of Security:

- **DART Rail Station:** DART Police patrol and surveillance light rail stops and assist with patrolling Downtown Dallas streets.
- **Inside and Outside:** Kay Bailey Hutchison Convention Center's security personnel remain vigilant during events by increasing outside surveillance, especially during our heaviest arrival and departure times.
- **Security Cameras:** Security cameras are keeping a watchful eye on all Exhibit Halls, in the VEX Dome (the Arena), Lobby Areas, and Corridor Areas.
- **Additional Security:** We will also have additional security available to support our KBHCC Security around the clock to ensure all areas are safe and each attendee can relax and have a wonderful experience.
- **Emergency Announcements:** In the event of an emergency, specific details and instructions are shared over the KBHCC public announcement system.

EMERGENCIES

For ALL Emergencies Remember:

- Tell a REC Foundation staff member to report the emergency.
- Disclose the exact location of the emergency (room number, exhibit hall, lobby, floor/level).
- Describe in as much detail as possible what happened or what was discovered that posed/created an emergency.
- Do not try to resolve the situation yourself.
- Once the emergency has been reported, a staff member assists with communication regarding the incident.

In the case of life-threatening emergencies, such as, heart attack, stroke, or severe allergic reaction, call KBHCC Security at **(214) 939-2940** for immediate assistance.

Do:

- Explain in as much detail as possible what has happened.
- Keep the person as calm and comfortable as possible and let them know that help is on the way.
- Help keep the area around the person clear to create room for first responders carrying equipment.

Don't:

Do not attempt to move an injured person

FIRST AID

First aid locations are available throughout KBHCC for your convenience and care.

Locations for First Aid:

- **Arena First Aid Room** is located on the second level concourse of the Arena.
- **A Ballrooms, Meeting Rooms A and the Theater** are covered from the Arena first aid room.
- **B, C and D Area First Aid Room** located in the first level C area next to meeting room C150. Halls B, C, D, C Ballrooms & all first level C meeting rooms are covered from this location.
- **E and F Area First Aid Room** located by the practice fields in Lobby F in the front of F Exhibit Hall.

Fire Safety

The Kay Bailey Hutchison Convention Center has many fire prevention features, fire alarm pull stations, a horn, light alarm system, and multiple fire extinguisher units. All are monitored and serviced for quality assurance on a regular basis. However smoke, extreme heat, burning smells and sparks can intensify, spread quickly, and destroy both property and lives. These should not be ignored. Fires and fire dangers should be contained if small and reported at the first sign to minimize damage and to protect those in their paths.

Do:

- Find a REC Foundation Staff Member to report a fire.
- Stay as calm as possible and listen carefully to follow any instructions given over the public address system.
- Touch doors to assure they're not hot before opening.
- Move quickly and in an orderly fashion to the nearest EMERGENCY EXIT and evacuate to the designated meeting location (see maps below).
- If smoke is present, cover your nose and mouth and avoid standing around while leaving the area.

Don't:

- Use elevators or escalators to evacuate the area/facility.
- Grab or pack up any items before evacuating the area/facility.

Tornado/Severe Weather

Texas' tornado season runs from March through June annually. KBHCCD Security has overall responsibility for the exercise and conduct of tornado/severe weather preparedness for the KBHCCD. In a tornado or any other severe weather-related emergency, KBHCCD Security will communicate with all guests, to minimize the disruption to normal event activities, and reduce property losses.

Do:

- Follow ALL instructions received from KBHCCD Security (either in-person or over the public address system).
- Avoid the following areas:
 - Spaces adjacent to exterior glass panels (windows, doors)
 - Exterior of the facility
 - Loading Docks
 - Catwalks
 - Elevators
 - Escalators
 - Electrical Rooms
- Remain in a sheltered location until instructed by KBHCCD Security to leave shelter areas.

Don't:

- Move or attempt to move vehicles or go outside the facility.
- Use elevators or escalators to move to tornado/severe weather shelter areas.
- Grab or pack up any items before moving to tornado/severe weather shelter areas.

Remember:

- Should a severe weather warning be issued, all guests will be notified and briefed ahead of time on KBHCC Emergency Operations Procedures by KBHCCD Security and a VEX Staff Member.
- KBHCCD Security staff will be onsite to direct all attendees if the weather emergency warrants onsite sheltering.

SAFETY ZONES AND FIRST AID LOCATION MAPS

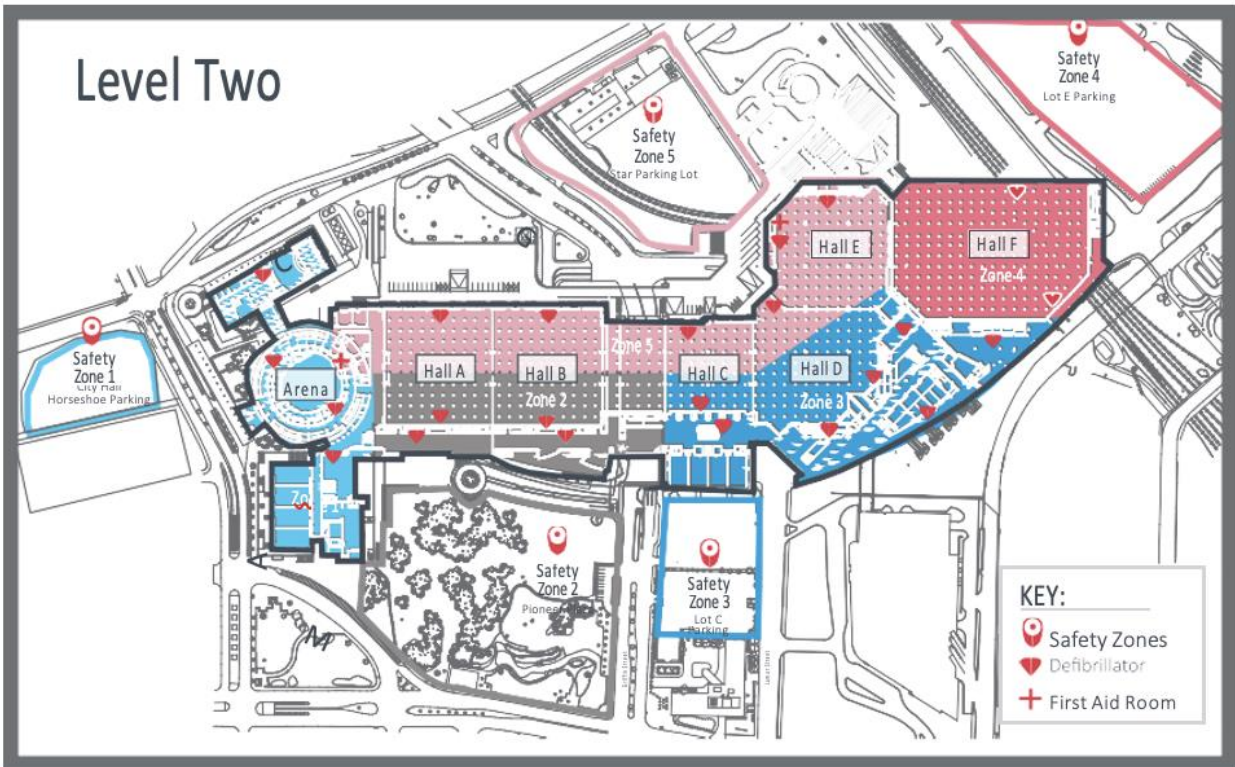
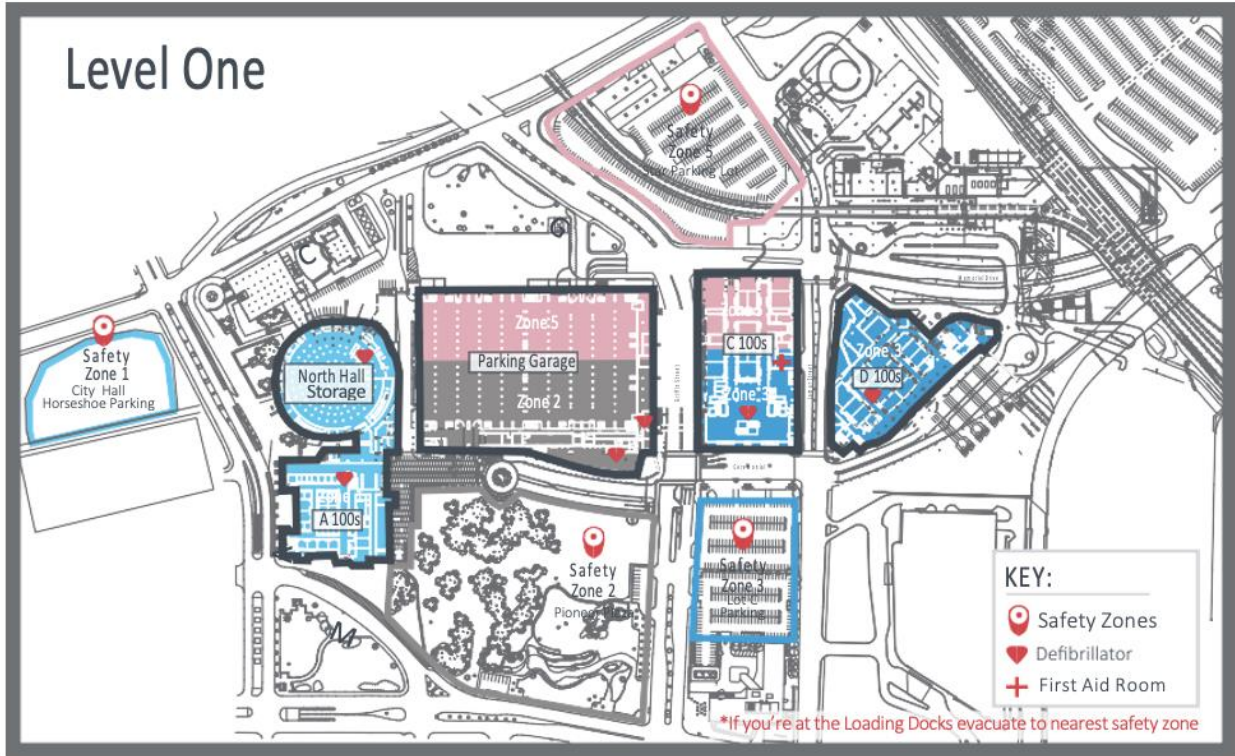

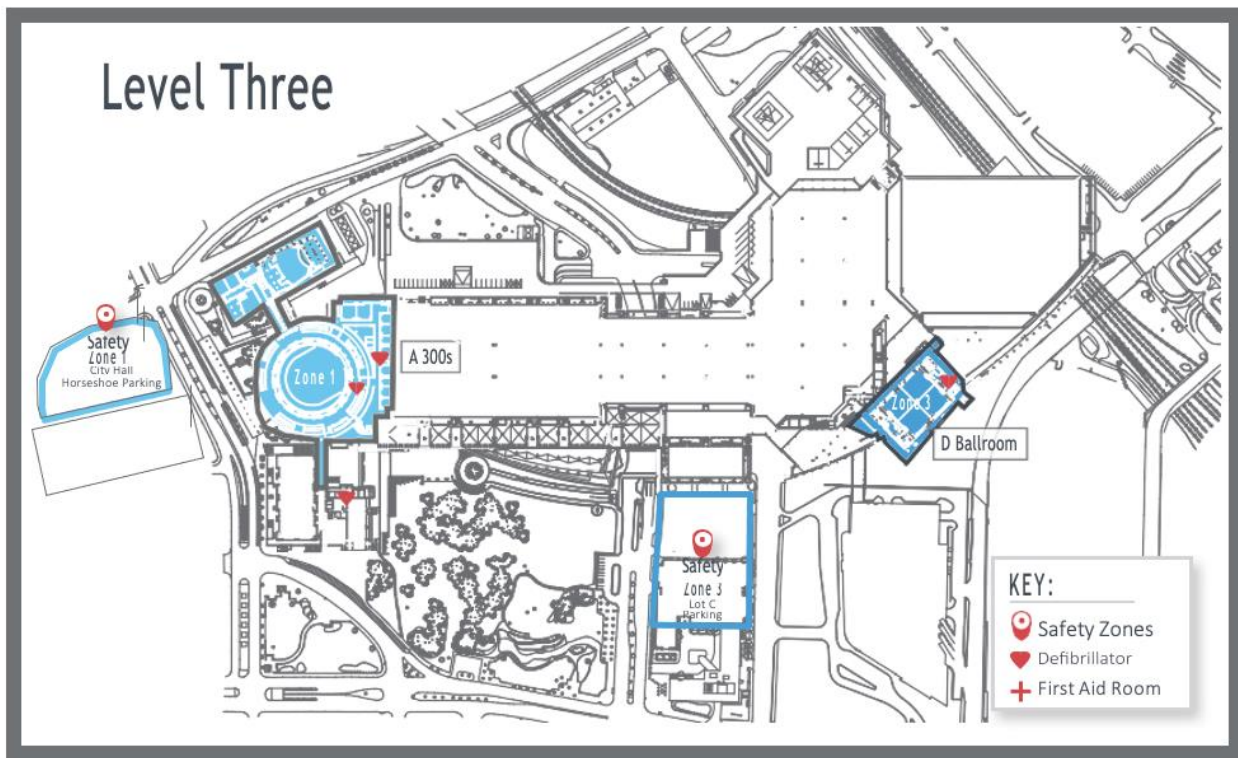

Internal Procedures:

- Contact a REC Foundation Staff Member.